

The ASB System40 wall is offering the best and easiest way of making your court better than ever before. With the state of the art ASB technology you will no longer need to worry about court surface cracks, uneven walls and incorrect ball rebounds.

Renovate with ASB System40

The ASB System40 wall is fixed to the existing building wall and is aligned vertically and horizontally. ASB technology helps to keep the distance between existing building wall and the ASB System40 wall. This cavity is filled with fire-dried sand, which is compressed.

After this installation the surface is without any visible joints and receives the final ASB playing surface coating. The ASB System40 has full WSF accreditation. The surface can also be painted in any desired pastel colour shade.

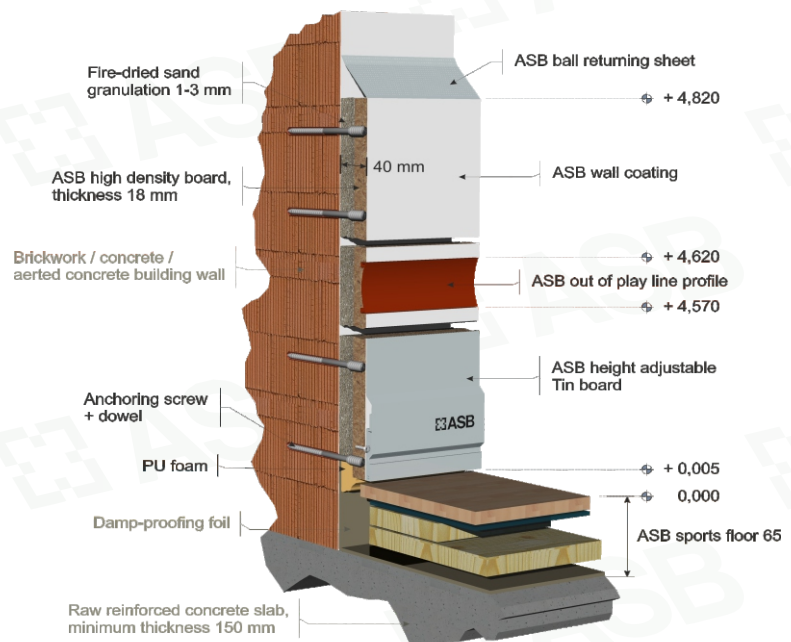

DETAIL D1 – ASB Front wall, System40

A squash ball causes a mini vacuum - negative pressure when it hits the wall at high speed (shown in red in the illustration on the left). This occurs because the part of the ball that hits the wall first also detaches itself first from the wall again. The sound created herewith gave the sport its name "Squassssh". Even the slightest unevenness causes the ball to suck off particles of the plaster and finally the known damages occur.

With the ASB System40 this can be solved once and for all

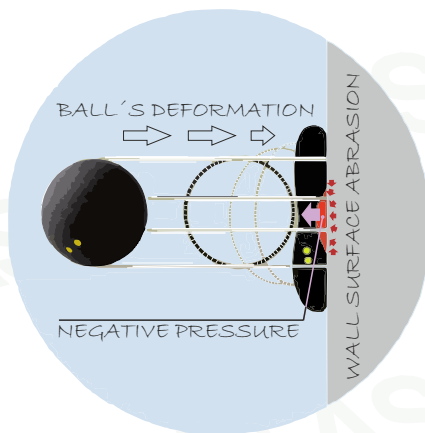

ASB MAIN ADVANTAGES:

- ASB is capable to level out differences in building walls, which ensures a completely straight wall and thus, the best playing characteristics
- The cavity between a building wall and an ASB panel is completely filled with a fire-dried sand – this means no hollow spots, the entire wall becomes very solid and the rebound is even and consistent, no matter where the ball hits the wall
- Simple and quick installation
- The ASB panels are 18 mm thick – ball gets closer to the fire-dried sand, therefore, the wall becomes harder, which leads to better playing characteristics
- Squash court wall's surface finish is smooth, solid and without joints or gaps
- Squash court walls cannot be harmed by static cracks
- Meets the international specifications
- Noise reduction
- Renovates every court



RENOVATED COURT
WITH ASB SYSTEM 40



✈ *Bad condition plaster court, before renovation*



RENOVATED COURT
WITH ASB SYSTEM 40



✈ *Bad condition plaster court, before renovation*